

Model : ATZ HDMI-V2-E70CL

Description: HDMI Extender over Cat5E/6 4K@60,18Gbps 70m POC IR HDMI loop EDID [TX/RX]



ATZ HDMI-V2-E70CL is a cost-effective point-to-point extender set for HDMI V2.0 and IR signals; this kit supports 4K/UHD video @ 60 Hz with 4:4:4 Chroma sampling, as well as HDMI data rates up to 18Gbps, HDCP 2.2 compliant; It provides HDMI transmission up to 230 feet (70 meters) for 4K@60Hz 4:4:4, or 262 feet (80 meters) for 1080p over single CAT5e/6 cable. It supports video resolution down-scaling, the 4K input can be automatically downscale to 1080p output for compatibility with 1080p display.

Model : ATZ HDMI-V2-E70CL

Description: HDMI Extender over Cat5E/6 4K@60,18Gbps 70m POC IR HDMI loop EDID [TX/RX]

Features:

- Supports HDMI V2.0, up to 4K@60Hz 4:4:4, HDR 10, 18G, HDCP 2.2.
- Extends signal up to 4K@70m and 1080p@80m over single CAT5e/6 cable.
- HDMI loop out on transmitter.
- Bi-directional IR pass-through.
- Supports video resolution down-scaling, the 4K input can be automatically degraded to 1080p output on receiver for compatibility with legacy 1080p display device.
- Features visually lossless compression with no latency.
- Smart EDID management.
- Compact design, easy to install and simple to operate.

Specifications:

Transmitter	
Input	(1) SOURCE
Input Connector	(1) 19-pin type-A female HDMI
Output	(1) DISPLAY, (1) CATx OUT
Output Connector	(1) 19-pin type-A female HDMI, (1) RJ45
Control	(1) IR IN, (1) IR OUT
Control Connector	(2) 3.5mm mini jacks
Receiver	
Input	(1) CATx IN
Input Connector	(1) RJ45
Output	(1) DISPLAY
Output Connector	(1) 19-pin type-A female HDMI
Control	(1) IR IN, (1) IR OUT
Control Connector	(2) 3.5mm mini jacks
General	
Video Resolution	Up to 4K@60Hz 4:4:4, HDR 10
HDMI Audio Format	Supports LPCM 2ch, LPCM 5.1ch, LPCM 7.1ch, Dolby Digital 2ch, Dolby Digital 5.1ch, DTS 2ch, DTS 5.1ch, DTS 96/24 5.1ch.
Transmission Distance	4K/1080p ≤ 70 meters (230ft)
	Note that the CATx cable length should not be less than 15 meters for best video output..
HDMI Version	HDMI V2.0

Model : ATZ HDMI-V2-E70CL

Description: HDMI Extender over Cat5E/6 4K@60,18Gbps 70m POC IR HDMI loop EDID [TX/RX]

HDCP Version	HDCP 2.2 compliant. (The HDCP of output follows the HDCP version of display device.)
EDID	EDID management
Power Supply	Input: 100VAC~240VAC, 50/60Hz;
	Output: 12VDC 1A
Power Consumption	4W (Max)
Operation Temperature	-5~55°C
Storage Temperature	-25~70°C
Relative Humidity	10%-90%
Dimensions (W*H*D)	80mm x 16.8mm x 80mm
Net Weight	TX/RX: 70g
<i>Note: The extender set does not support HBR audio</i>	

Transmitter Panel Description:

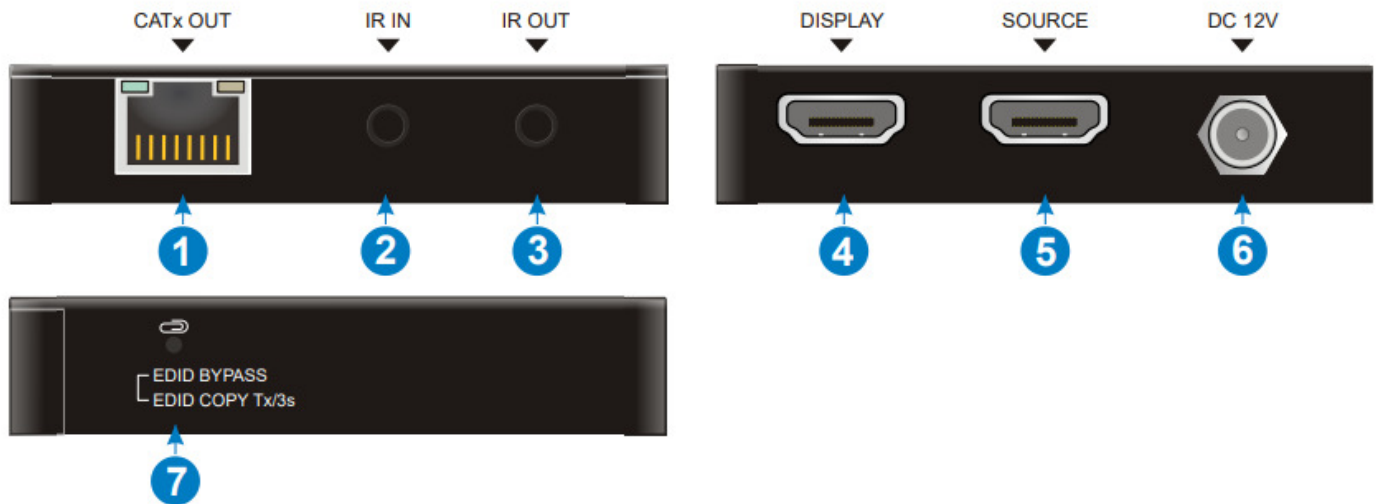

1. CATx OUT: RJ45 port to connect the CATx IN port of receiver by CATx cable. It supports 12V PoC to power the receiver. The orange LED illuminates when there is a valid HDMI signal input. The green LED illuminates when power is applied.

2. IR IN: 3.5mm mini jack to connect IR receiver for IR pass-through.

3. IR OUT: 3.5mm mini jack to connect IR emitter for IR pass-through.

4. DISPLAY: Type-A female HDMI port to connect HDMI display device.

5. SOURCE: Type-A female HDMI port to connect HDMI source device.

6. DC 12V: DC connector for the power adapter connection.

7. EDID Management:

- EDID BYPASS: Press the button with paper clip or other sharp tool to learn the EDID from the remote display connected to the Receiver's HDMI out.
- EDID COPY Tx/3s: Press and hold the button for 3 seconds to copy the EDID from

Model : ATZ HDMI-V2-E70CL

Description: HDMI Extender over Cat5E/6 4K@60,18Gbps 70m POC IR HDMI loop EDID [TX/RX]

the local display connected to the Transmitter's HDMI out.

- **DEFAULT:** Factory default, the source device learns EDID from the TV which has the lowest resolution. Press and hold the button while the product is in turned-off period, and then release the button after 6 seconds of power on can restore the default setting.

Note: If the standard resolution of the local display is lower than the receiver's, the unit will output the video with the lower resolution to ensure video can be shown on both displays.

Receiver Panel Description:



- 1. DISPLAY:** Type-A female HDMI port to connect HDMI display device.
- 2. CATx IN:** RJ45 port to connect the CATx OUT port of transmitter by CATx cable. It supports 12V PoC and the receiver can be powered from the transmitter. The orange LED illuminates when there is a valid HDMI signal input. The green LED illuminates when power is applied.
- 3. IR IN:** 3.5mm mini jack to connect IR receiver for IR pass-through.
- 4. IR OUT:** 3.5mm mini jack to connect IR emitter for IR pass-through.

Package Includes:

- 1x Transmitter (Tx)
- 1x Receiver (Rx)
- 1x IR Receiver
- 1x IR Emitter
- 2x Velcro Strips
- 1x Power Adaptor (12V DC 1A)
- 1x User Manual

Model : ATZ HDMI-V2-E70CL

Description: HDMI Extender over Cat5E/6 4K@60,18Gbps 70m POC IR HDMI loop EDID [TX/RX]

Product Diagram:

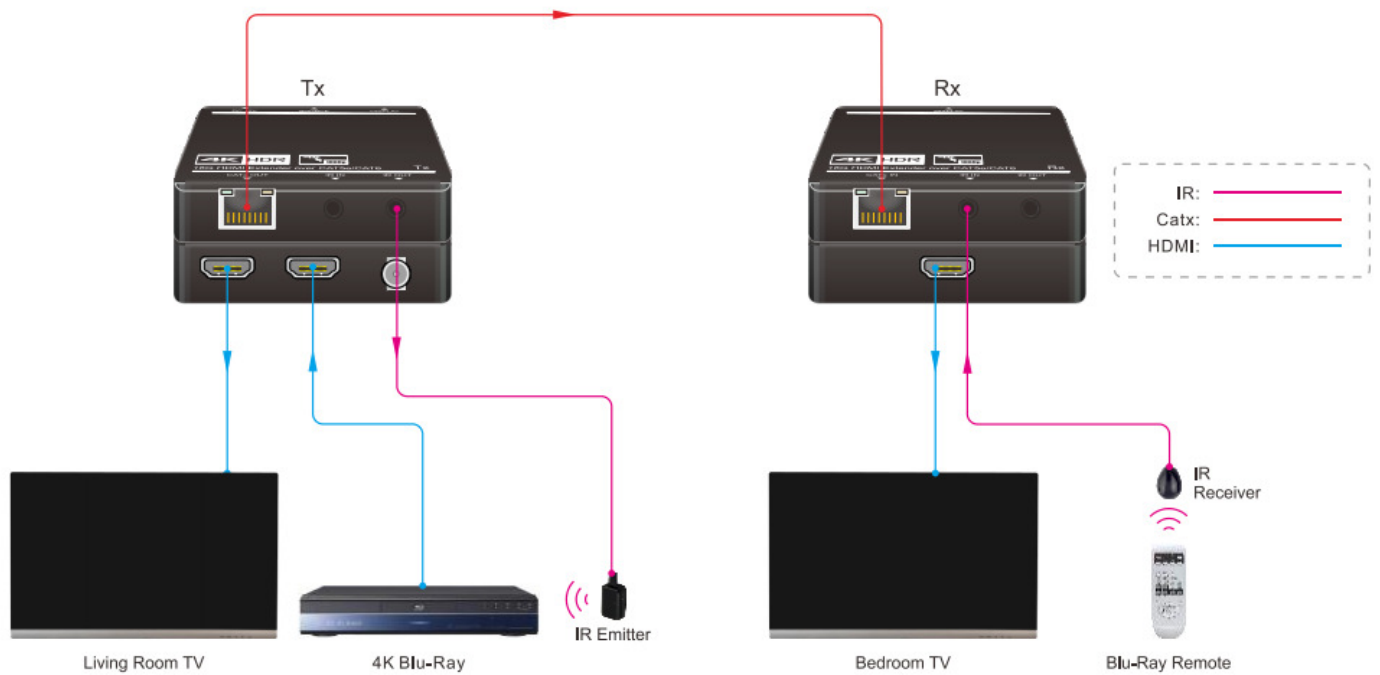

Warranty: 2 Years

Warranty is effective from the date of original delivery.

This warranty shall be void if a serial number has been removed from the product.